

DRUM HANDLING EQUIPMENT

For Steel, Fiber and Plastic Drums



Beacon Industries, Inc.
12300 Old Tesson Rd.
St. Louis, MO 63128-2247 USA
Phone: (314) 487-7600 Fax: (314) 487-0100
E-Mail: sales@beacontechnology.com
beacontechnology.com

DRUM HOIST

BPDL-800-M

- Simple Design is Easy to Use
- Completely Mechanical Operation

Simple three-arm design for use with closed head 30 and 55 gallon plastic, steel and fiber drums with top lip. Each removable arm also functions as a wrench for use on drum plugs, faucets and rim ring bolts. Durable powder coat finish.



Patent Pending



Model Number	Acceptable Drum Type	Capacity (pounds)
BPDL-800-M	55 Gallon Plastic, Fiber & Steel Drums	800

PLASTIC DRUM LIFTER

BPDL-800

Designed to handle 55 gallon plastic drums, as well as traditional steel drums. Automatic secure and release eccentric lock makes this drum handler a real time saver. Includes adjustable positioning feature for increased adaptability. Capacity is 800 lbs.

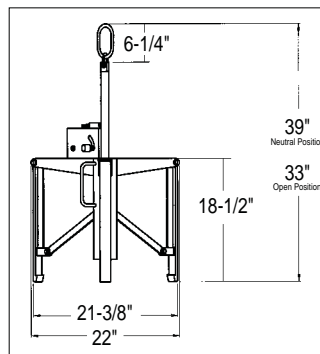

Model Number	Acceptable Drum Type	Capacity (pounds)
BPDL-800	55 Gallon Plastic & Steel	800

BARREL LIFTER

BDCL

The Drum Clutcher allows easy lifting and transporting of steel drums with an overhead lifting chain or hoist. The Drum Clutcher is ideal for placing drums in secondary containment and salvage drums. The BDCL series is designed for steel drums with a top lip or chime. Not for use with open head drums.



Model Number	Acceptable Drum Type	Capacity (pounds)
BDCL-550	30 Gallon Steel Drums	1,000
BDCL-1000	55 Gallon Steel Drums	1,000

DRUM LIFTING EQUIPMENT

BVDL-22.5

This Drum Lifting Equipment provides easy lifting and transporting of drums. Made of solid steel construction the model **BVDL-22.5** has a capacity of 1,000 lbs. Simply lower unit onto the drum and as the lifter is elevated the positive gripping pads secure the drum. When the drum is set down, the model carriage drops down, locking itself in an open position, ready for another drum. Use on 55 gallon steel drums with a top lip or chime. Not for use with open head drums.



Model Number	Acceptable Drum Type	Capacity (pounds)
BVDL-22.5	55 Gallon Steel Drum	1,000