

# OWNER'S MANUAL

## SEMI-AUTOMATIC STRETCH WRAP MACHINE MODEL BSWA-48, BSWA-54 & BSWA-60

### Contents

Warnings and Safety Instructions .....	1	Parts Identification for BPMO .....	7
Receiving Instructions .....	1	Torque Limiter Readjustment (BSWA-48) .....	8
Assembly Instructions .....	2	Torque Limiter Readjustment (BSWA-54, 60) ....	9
Recommendations for Wrapping .....	2	BSWA Mast Assembly .....	10
Safety Instructions for Operator .....	2	Optional Film Rods .....	10
Replacement Parts .....	2	Electrical Diagram .....	11
Periodic Maintenance Instructions .....	3	Electronic Drive Parameter Settings .....	12
Parts Drawing for BSWA-48 .....	4	Troubleshooting .....	13
Parts Identification for BSWA-48 .....	5	Warning Label Identification .....	14
Powered Mast Option Drawing .....	6	Limited Warranty/Service Record .....	15

### WARNINGS & SAFETY INSTRUCTIONS

#### *Read owner's manual completely before operating unit!*

- Remove load & disconnect power before working on unit.
- Do not stand on carousel when unit is running.
- Stand clear of load while operating the stretch wrap holder.
- Never operate unit unless you are watching it.
- Never exceed maximum capacity of 4000 lbs. (BSWA-48) or 5,000 lbs. (BSWA-54 and BSWA-60).
- Maximum load size is 76" (BSWA-48) or 86" (BSWA-54 and BSWA-60).
- Maximum wrapped load height is 78" (BSWA-48) or 75" (BSWA-54 and BSWA-60).
- Maximum film roll diameter is 11 inches.
- Load palletized product in the center of the carousel.
- Consult factory for uneven loading.
- Do not continue to step on foot control pedal if carousel is not turning.
- Use only replacement parts supplied or approved by the manufacturer.
- Consult factory if adding or performing any modifications to the original equipment.
- Make sure all operator safety labels are in place (p.11).

### RECEIVING INSTRUCTIONS

Every unit is thoroughly tested and inspected prior to shipment. However, it is possible that the unit may incur damage during transit. If you see damage when unloading make a note of it on the SHIPPER RECEIVER.

Remove all packing and strapping material, inspect for damage. IF DAMAGE IS EVIDENT, FILE A CLAIM WITH THE CARRIER IMMEDIATELY! Also, check the unit size, type of power unit, etc., to ensure the unit is correct for the intended application.

### MODEL NUMBER AND CAPACITY

The model number, serial number and capacity is inscribed on the nameplate. Please remember to include these numbers in any correspondence with your dealer or the factory.

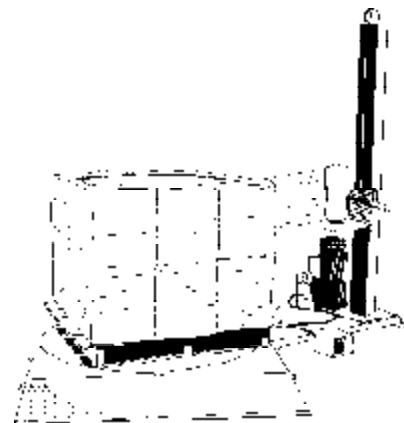

**SEMI-AUTOMATIC STRETCH WRAP MACHINE  
MODEL BSWA-48, BSWA-54 & BSWA-60**

---

## LOADING INSTRUCTIONS

The load capacity rating as inscribed on the nameplate of your unit designates the net capacity, assuming a load centered and evenly distributed on the carousel. This capacity must never be exceeded, as permanent damage or personal injury could result. Never drop a palletized load on to carousel as damage or injury could result.

## ASSEMBLY INSTRUCTIONS

Remove powered carousel and stretch wrap mast from the crate. Check carefully for damage and report any damage immediately. Place a 4" x 4" board under the motor end of the powered carousel. This will raise the unit sufficiently for placement of the stretch wrap mast mounting bolts. Stand stretch wrap mast upright and align holes of the mast mounting plate with the holes on the carousel base frame. Be sure that the stretch wrap mechanism is facing outward. Secure the mast to the base with the bolts provided. Remove the retaining screw from the stretch wrap mast to release the counter balance weight. Remove the 4" x 4" board and lag the carousel frame to floor.

Unscrew and remove the plastic handle (tension grip) on the top of the stretch wrap holder shaft. Remove both stretch wrap retainers and insert them in the ends of the stretch wrap spool, placing the top retainer containing the thrust bearing at the top of the stretch wrap spool. Slide the stretch wrap spool over the stretch wrap holder shaft. The bottom stretch wrap retainer will ride on the fiber washer. Replace plastic handle.

**(PLEASE REFER TO BSWA MAST ASSEMBLY DIAGRAM ON PAGE 10)**

## RECOMMENDATIONS FOR WRAPPING

Plug power unit into a 120 VAC grounded receptacle. Place palletized product in the center of the carousel. Begin with the stretch wrap at the bottom of the mast and the tension set loose for easy flow of stretch wrap. Attach the stretch wrap to the pallet or palletized product.

Set the carousel speed for a slow rotation and step on the foot switch pedal. The carousel speed adjustment is located on the front of the speed control enclosure. The height of the stretch wrap is adjusted manually by either pushing up or pulling down on the horizontal handle until the desired height is reached.

As the carousel begins to turn, slowly move the stretch wrap up to the top of the palletized products. The initial wraps secure the product together. When the top of the product is reached, wrap three or four turns at the top and then begin to move the wrap down, overlapping the previous wrap by approximately 1/2.

You can increase the tension on the wrap by turning the plastic handle on the top of the stretch wrap holder shaft clockwise, and reduce the tension by turning the handle counter clockwise.

**CAUTION:** Excessive wrap tension adjustment can cause premature wear of the torque limiter.

## SAFETY INSTRUCTIONS FOR THE OPERATOR



Always load the unit properly. Load palletized product in the center of the carousel. Do not drop pallet on carousel.



Never use the carousel if it is in need of repairs or in the case of a malfunction.



Notify your maintenance personnel or supervisor in case you notice anything out of the ordinary, such as binding, odd motor noises etc.



Do not continue to step on the foot switch pedal if the carousel is not turning. The motor may be permanently damaged.

## ORDERING REPLACEMENT OR EXTRA PARTS

Our company takes pride in using the finest available parts for our equipment. We are not responsible for equipment failure resulting from the use of unapproved replacement parts. To order replacement or extra parts for your equipment contact Customer Service at the factory. In any correspondence with the factory please include the **Serial Number** which is inscribed on the nameplate of the piece of equipment. Use only the part numbers provided in this Owner's Manual recommended for this machine.

---

## PERIODIC MAINTENANCE INSTRUCTIONS

### (A) Before Each Use Check For The Following :

- 1.) Frayed wires
- 2.) Structural deformation of carousel or frame
- 3.) Unusual noise or binding

***If you find any of the above, discontinue use of the machine until the necessary repairs are made by a qualified individual!***

### (B) Inspect Monthly for:

- 1.) Torque limiter slippage due to friction pad wear. See 8 and 9.
- 2.) Carousel bearing and chain wear.
- 3.) Worn or damaged electrical cords.
- 4.) Shrink-wrap material under the turntable.
- 5.) Unusual noise when operating.
- 6.) Gear reducer oil leaks.
- 7.) Missing or illegible warning labels.
- 8.) Blocked ventilation ports on the motor speed controller.



**BE SURE ALL POWER IS OFF BEFORE ATTEMPTING TO WORK ON THIS EQUIPMENT!**  
**CAUTION: SERVICE WORK SHOULD BE PERFORMED ONLY BY TRAINED & QUALIFIED PERSONNEL.**  
**WAIT SEVERAL MINUTES AFTER REMOVING AC POWER BEFORE OPENING THE MOTOR CONTROLLER!**

### ***Avoid overloading the turntable!***

The drive unit of the BSWA is protected from overload and shock-loading by a torque limiter device that is designed to slip only in the event of an overload condition.

An overload will occur:

- When there is excessive weight on the turntable (-48: 4,000lbs.: -54, -60: 5,000 lbs.)
- If there is too much tension on the stretch-wrap material as it's pulled off the roll
- When the rotating load is stopped suddenly
- If the drive chain, sprocket, or bearings become bound with stretch-wrap material
- If placing a pallet on, or removing a pallet from, the turntable while it is rotating
- If the pallet hangs below the turntable and strikes the machine's frame of ramp
- When the load comes into contact with any immovable object

Infrequent maintenance checks can result in continuous slippage of the torque limiter sprocket, which will cause the turntable to rotate slower than intended. It will also lead to the premature failure of the torque limiter's friction disks and bushing, which will not be covered under warranty.

In the event of a sudden a severe shock-load to the stretch-wrap turntable, such as when the load is stopped instantaneously while spinning due to a fork truck backing too close to the load, damage could occur to the drive system components (chain, sprocket, torque limiter, gear reducer, motor).

The gear reducer was filled with oil at the factory to operate within a 15°F to 125°F ambient temperature range. It is permanently lubricated. There's no requirement for oil changes.

The disassembly of the gear reducer will void its warranty, and at the factory's discretion may void all warranty of the stretch-wrap machine.

# BSWA-48 SEMI-AUTOMATIC STRETCH WRAP MACHINE

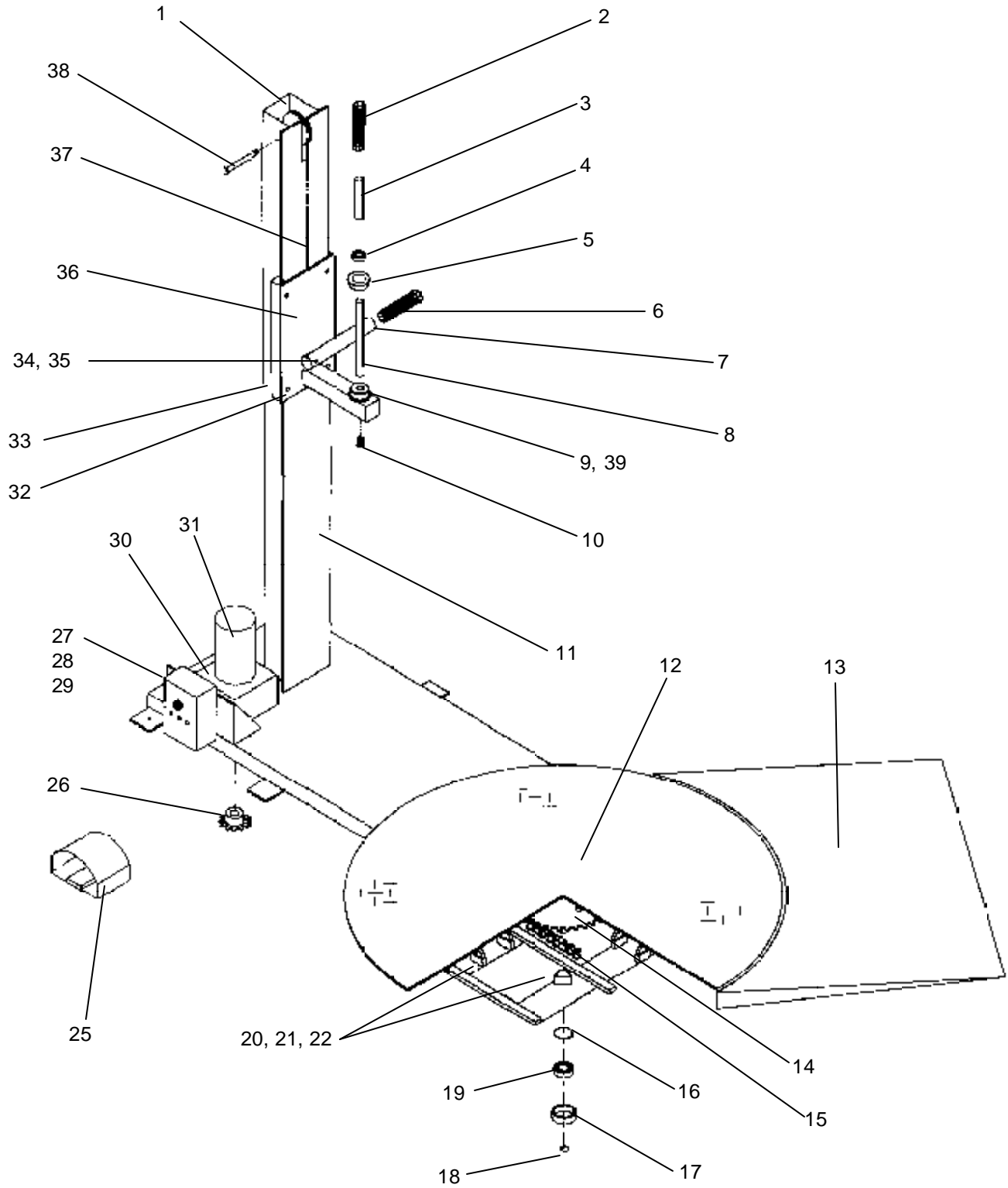

## PARTS IDENTIFICATION

### BSWA-48 SEMI-AUTOMATIC STRETCH WRAP MACHINE

ITEM NO.	DESCRIPTION	ENGINEER NO.	PART NO.	QTY.
1	Pulley for Counter Balance Weight	B20-027-001	BSWA-CBWP	1
2	Rubber Handle Grip	B13-025-003	BSWA-RHGR	1
3	Plastic Handle (threaded insert, 3/4-10 UNC)	B20-025-001	BSWA-PHN	1
4	Tension Ball Bearing (pressed into part 5)	B20-110-002	BSWA-TBB	1
5	Top Stretch Wrap Retainer	B20-014-006	BSWA-TRET	1
6	Brake Handle Grip (slip on)	B13-025-003	BSWA-BRGR	1
7	Brake Handle	B20-037-003	BSWA-BRHD	1
8	Stretch Wrap Holder Shaft (specify length of wrap)	B20-026-001	BSWA-SWS	1
9	Bottom Stretch Wrap Retainer	B20-014-005	BSWA-BRET	1
10	Bolt, 3/8"-16 x 1" (HHCS) w/ lock washer	A/L	A/L	1
11	Mast Assembly (carriage not included)	B20-514-005	BSWA-MAST	1
12	48 inch Diameter Tread Plate Deck	B20-013-004	BSWA-DECK	1
13	Optional Ramp (for use with pallet jack trucks)	B20-514-004	BSWA-RAMP	1
14	Driven Gear and Shaft (bolts on item no. 12)	B20-152-001	BSWA-DRVNG	1
15	Drive Roller Chain	B20-042-003	BSWA-DRC	1
16	2" Snap Retainer Ring	B20-117-001	BSWA-SRR2	1
17	Bearing Housing (welded to base frame)	B20-020-001	BSWA-BH	1
18	1" Snap Retainer Ring	B20-117-003	BSWA-SRR1	1
19	Main Bearing	B20-110-001	BSWA-MB	1
20	Load Bearing	B20-110-003	BSWA-LB	10
21	Bolt, 5/16"-18 x 2 1/4" (HHCS) 2 Flat Washer & Lock Nut	A/L	A/L	10
22	Bracket for the Load Bearing (welding required)	B20-016-001	BSWA-LBB	10
25	Foot Control with Clipper Guard and 8" Cord	B20-022-001	BSWA-FC	1
26	Torque Limiter with 16th Sprocket	B20-152-002	BSWA-TRQLMT	1
27	Control Box for Variable Speed, 115V	B20-029-006	BSWA-DELTA-115	1
28	Control Box for Variable Speed, 230V	2B0-029-007	BSWA-DELTA-230	1
29	Control Box for Variable Speed, 460V	2B0-029-008	BSWA-DELTA-460	1
30	Gear Reducer, Hub City	2B0-141-002	BSWA-GBOX	1
31	3 Phase 230V Motor, 1/2 HP	2BB0-135-003	BSWA-ACMTR	1
32	Bolt, 5/16"-18 x 2" hex. head w/ lock nut	A/L	A/L	4
33	Carriage Glide Rails	B20-014-007	BSWA-CGLR	2
34	Spring Washers, 3/4" dia. x .06" thk.	A/L	A/L	12
35	Bolt for Spring Washers (machined head)	B20-118-001	BSWA-SWBOLT	1
36	Mast Slide Assembly	B20-514-008	BSWA-MSA	1
37	Counter Balance Weight with Cable	B20-017-007	BSWA-CBW	1
38	Bolt, 3/8"-16 x 5" shoulder bolt w/ nylock nut	A/L	A/L	1
39	Fiber Washer, 3" dia.	B20-113-003	BSWA-FW	1

A/L Available at local hardware store  
A/K Available only with purchase of kit

# BSWA-PMO • POWERED MAST OPTION

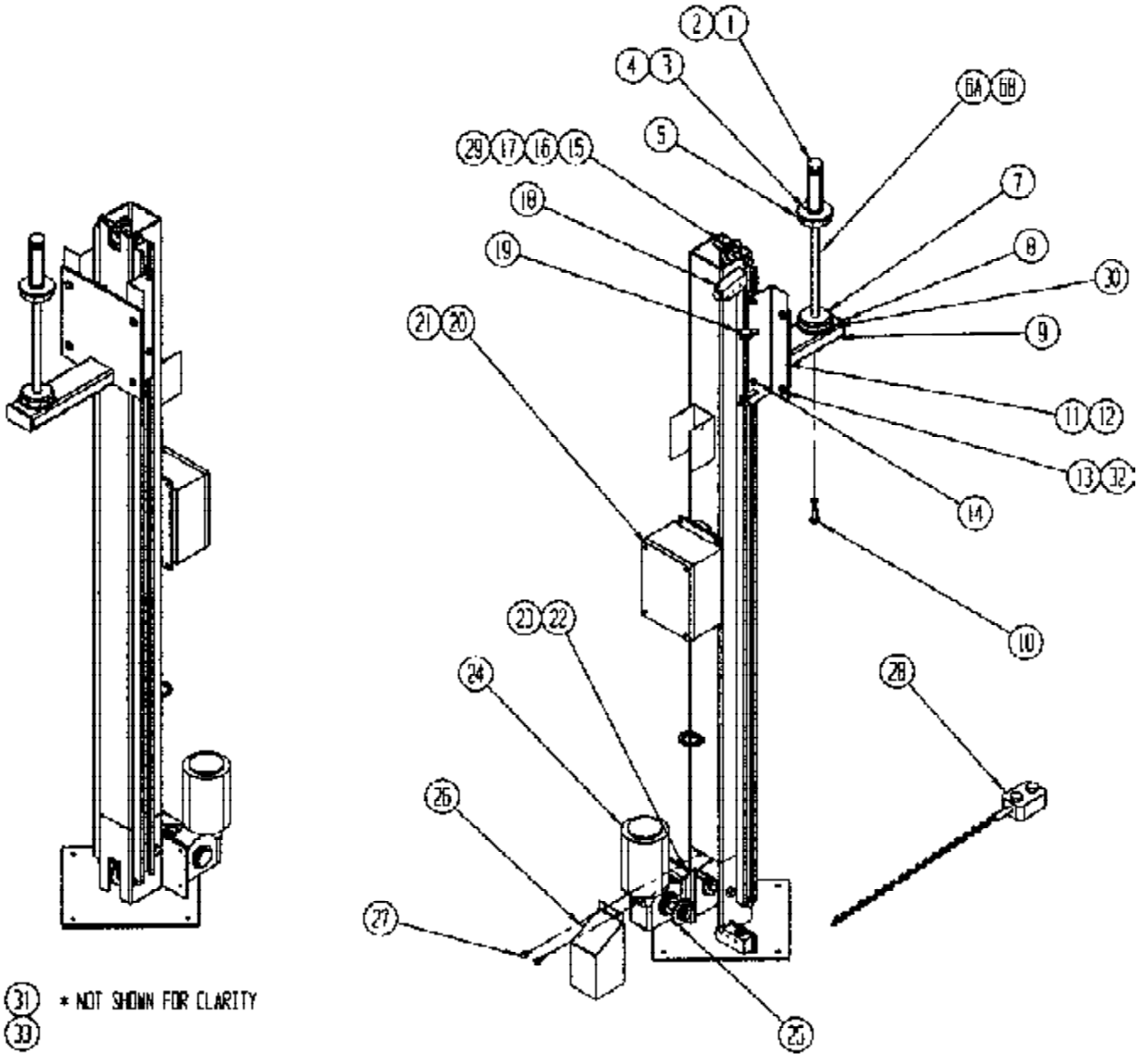

## PARTS IDENTIFICATION SBWA-PMO • POWERED MAST OPTION

ITEM NO.	DESCRIPTION	ENGINEER NO.	QTY.
1	Handle / Grip	B20-025-001	1
2	Grips, 1-1/8 dia. white	B13-025-003	1
3	Snap Ring	B20-117-002	1
4	Ball Bearing with Shield	B20-110-002	1
5	Frame, Tube Retainer	B20-014-006	1
6a	Holder, Shaft, 25-1/2"	B20-026-002	1
6b	Holder, Shaft, 15-1/2"	B20-026-001	1
7	Frame, Tube Retnr, btm	B20-014-005	1
8	Guard/Cover Plastic	B20-024-003	1
9	Ass'y Brk Mast, Slide Plt	B20-516-004	1
10	3/8-16 x 1-1/4 Bolt & Lk Wsr	N/A	1
11	Frm, Slide Ang, Wldmnt	B20-514-019	1
12	Brkt, Mast, Rolr, Rt	B20-016-026	1
13	5-1/6-18 x 3/4 Bolt	N/A	4
14	Brg, Roller with 5/16-8 Nylock	B20-110-008	4
15	Sprocket, Idler	B20-042-008	3
16	Bolt, 1/2-13 x 4-1/2" Lg.	N/A	3
17	Spacer	B20-113-005	6
18	Switch, Plunger, Limit	B01-022-021	2
19	Elv Bolt 1-1/2 with 1/4-20 Nut	N/A	1
20	6 x 8 Junc Box	B01-029-003	1
21	10-24 x 3/4 Blt, Nylocks & Wsr.	N/A	4
22	1/4-20 x 1 with Nylocks	N/A	2
23	1/4-20 x 3/4 with Nylocks	N/A	2
24	Baldor Motor	B20-141-003	1
25	Sprocket, Drive	B20-042-009	1
26	Ass'y Guard Cover Plt	B20-524-001	1
27	5/16 x 3/4 Self Tapping	N/A	2
28	2 Button H/C with 112" cord	B01-522-015	1
29	1/2-13 Nylock, 1/2 Washer	N/A	3
30	Fiber Spacer	B20-013-003	1
31	Chain, Roller, #35	B20-042-010	1
32	5/16-18 Nylocks with 5/16 Washer	N/A	4
33	Cord, 9 foot, with 15 amp Molded Plug	B01-033-015	1

A/L Available at local hardware store  
A/K Available only with purchase of kit

## TORQUE LIMITER READJUSTMENT FOR BSWA-48

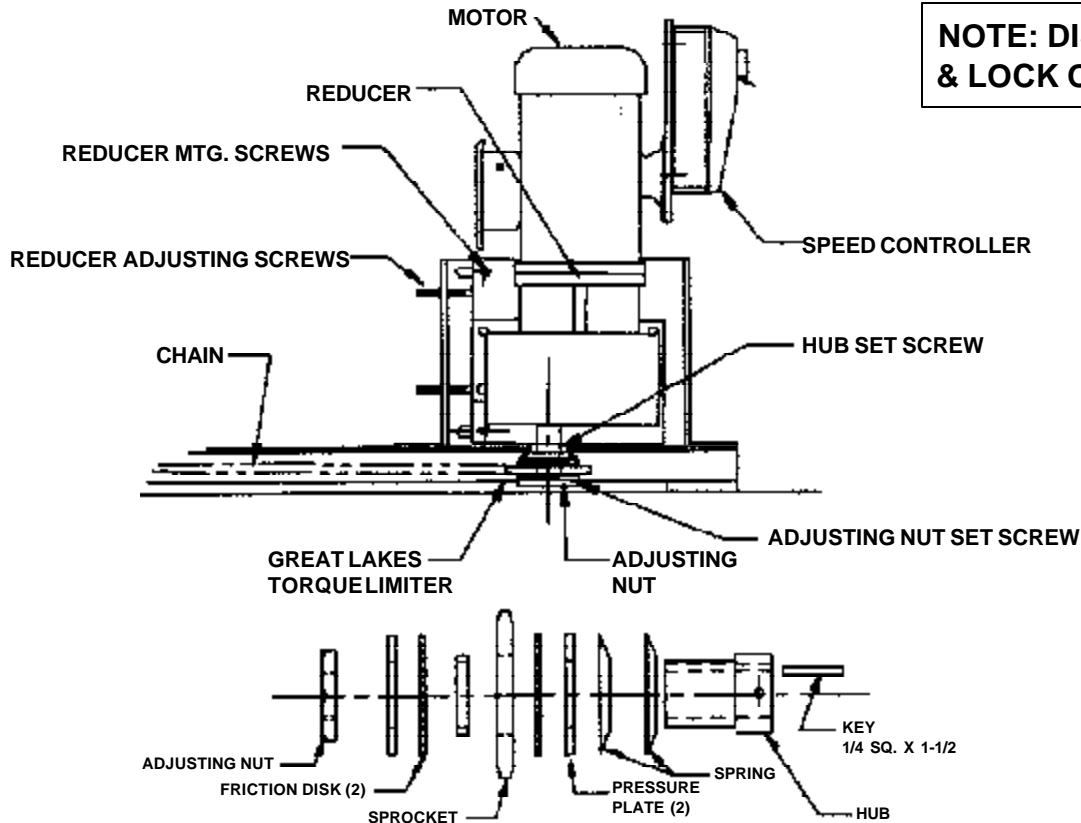

- 1) Raise motor end of BSWA-48 and secure, to remove chain tension, loosen reducer mounting screws (4) and back out reducer adjusting screws (2).
- 2) Loosen the torque limiter adjusting nut set screw and the adjusting nut.
- 3) Adjust the nut to finger tight.
- 4) Match mark the adjusting nut and hub, advance the adjusting nut 1-1/2 to 1-3/4 turns. Tighten adjusting nut set screw in nearest spline notch.
- 5) Repeat #1 in reverse, the chain should be taut but not tight.
- 6) Note: The motor/reducer should have a slight tilt to the right.
- 7) Run turntable and check torque limiter for slippage and the chain & sprocket for correct alignment. The chain should be taut but not tight.

### RUN-IN PROCEDURE FOR REPLACEMENT TORQUE LIMITER

- 8) Perform #1.
- 9) Loosen hub set screw and remove torque limiter.
- 10) Install new torque limiter with key and tighten hub set screw. Locate end of hub 1/2" ID 9/16" from reducer shaft.
- 11) Perform #1 in reverse, chain should be taut but not tight.
- 12) "Run In" the torque limiter by slipping the sprocket as follows:
- 13) Loosen adjusting nut set screw and adjust nut to finger tight.
- 14) Match mark the adjusting nut and hub. Advance the nut 1/4 turn.
- 15) Retain the turntable deck from rotating, slip the sprocket for 3-4 minutes by depressing the foot pedal at full controller speed.
- 16) Perform #2, #3, #4.
- 17) Review #6 and #7.

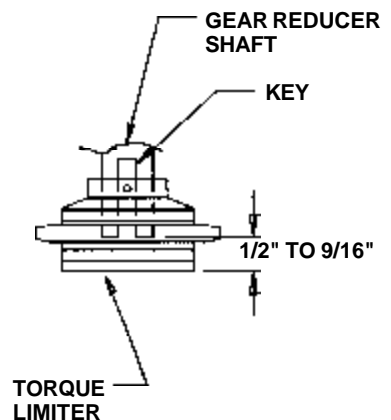

## TORQUE LIMITER READJUSTMENT FOR BSWA-54 & BSWA-60

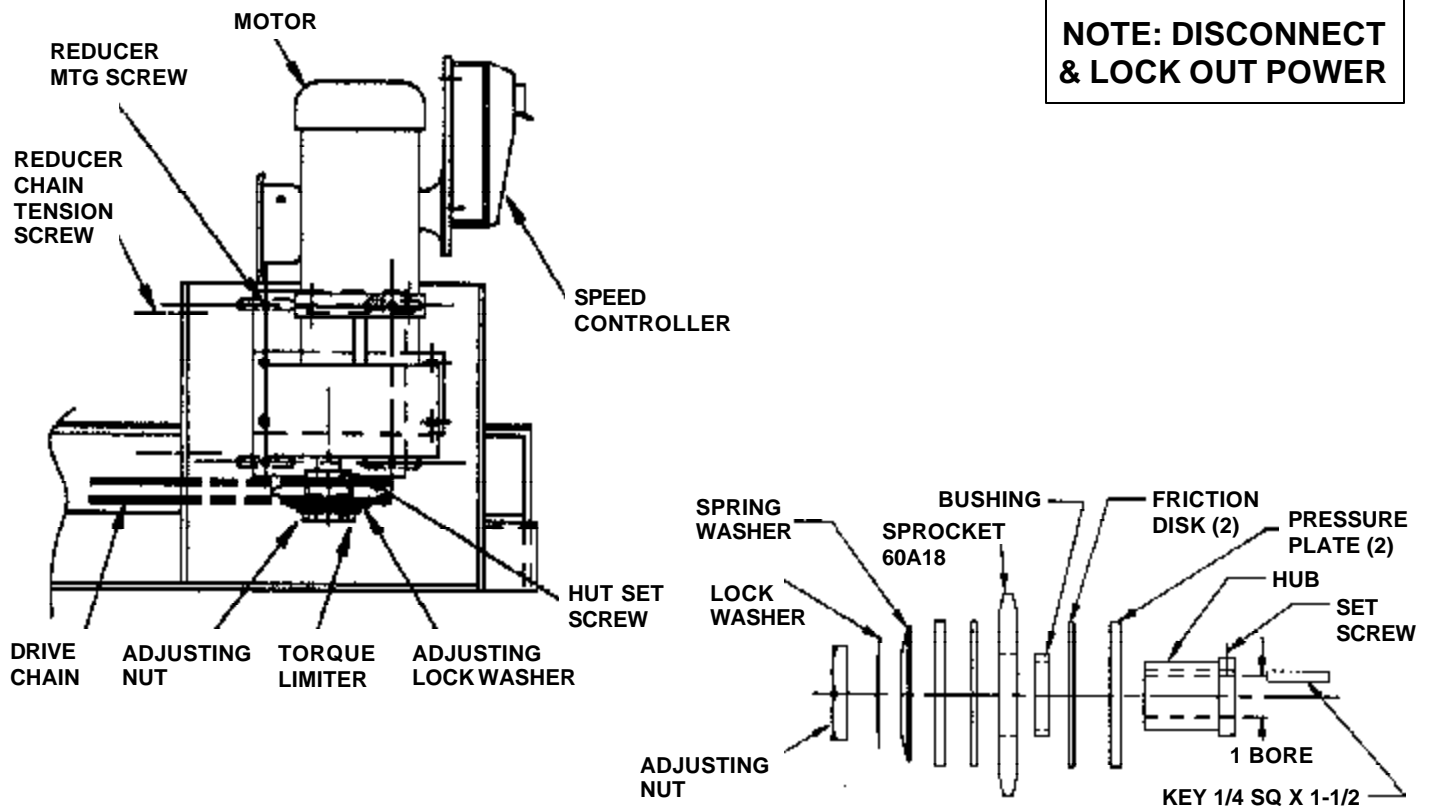

- 1) Raise motor end of BSWA-54 and secure, to remove sprocket guard, to remove chain tension, loosen reducer mounting screws (4) and back out reducer adjusting screws (2).
- 2) Bend adjusting lock washer tabs flat and loosen the adjusting nut.
- 3) Adjust the nut to finger tight.
- 4) Match mark the adjusting nut and hub, advance the adjusting nut 1-1/4 to 1-1/2 turns. Bend down 2 or 3 adjusting lock washer tabs.
- 5) Repeat #1 in reverse, the chain should be taut but not tight.
- 6) Note: The motor/reducer should be vertical. See view below.
- 7) Run turntable and check torque limiter for slippage and the chain & sprocket for correct alignment. The chain should be taut but not tight.

### RUN-IN PROCEDURE FOR REPLACEMENT TORQUE LIMITER

- 8) Perform #1.
- 9) Loosen hub set screw and remove torque limiter.
- 10) Install new torque limiter with key and tighten hub set screw. Locate end of hub 1/2" ID 9/16" from reducer shaft end.
- 11) Perform #1 in reverse, chain should be taut but not tight.
- 12) "Run In" the torque limiter by slipping the sprocket as follows:
- 13) Loosen adjusting nut set screw and adjust nut to finger tight.
- 14) Match mark the adjusting nut and hub. Advance the nut 1/4 turn.
- 15) Retain the turntable deck from rotating, slip the sprocket for 3-4 minutes by depressing the foot pedal at full controller speed.
- 16) Perform #2, #3, #4.
- 17) Review #6 and #7.

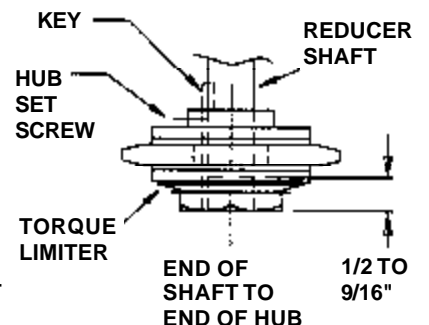

## BSWA MAST ASSEMBLY DIAGRAM

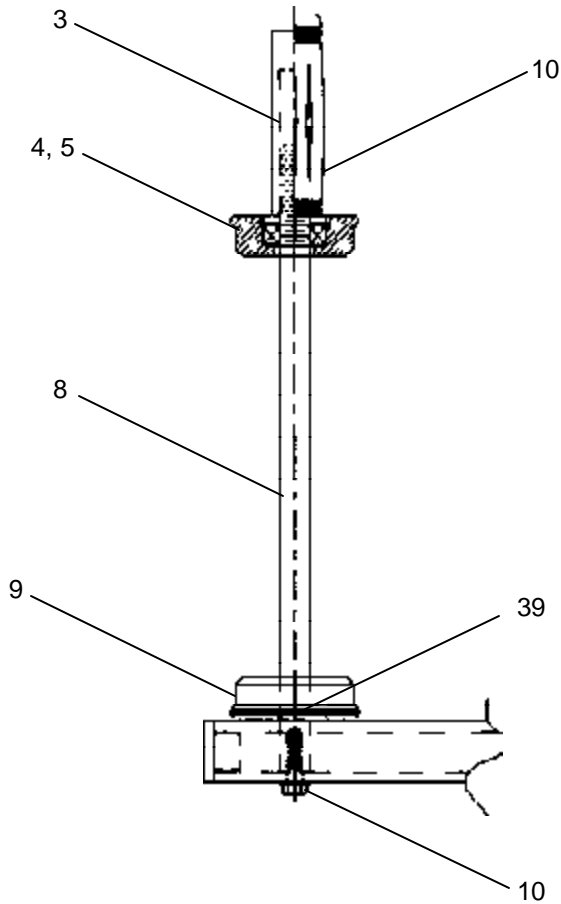

- 2.) RUBBER HANDLE GRIP
- 3.) PLASTIC HANDLE INSERT
- 4 & 5.) \*TOP STRETCH WRAP RETAINER W/BALL BEARING & SNAP RING
- 8.) SHAFT
- 9.) \*BOTTOM STRETCH WRAP RETAINER (SOLID)
- 39.) 3" dia. FIBER WASHER
- 10.) BOLT, 3/8"-16 x 1" (HHCS) w/ LOCK WASHER

\*TOP AND BOTTOM STRETCH WRAP RETAINERS MUST BE IN PROPER POSITIONING FOR HANDLE TO PUT TENSION ON FILM

\*DO NOT SWITCH TOP AND BOTTOM STRETCH WRAP RETAINERS!! \*

## OPTIONAL FILM RODS

DESCRIPTION	MODEL NO.	WEIGHT
45"H Film Rod	BSWA-ROD-45	11 lbs.
65"H Film Rod	BSWA-ROD-65	13 lbs.
45"H & 65"H Film Rod	BSWA-ROD-COMBO	24 lbs.

- A 15" & 25" Film Rod (along w/ Handle, (2) Plastic Retainers, Bearing, & Fiber Washer) go out with every purchase unless specified.
- The 15" Rod Holds 10"H Material
- The 25" Rod Holds 20"H Material
- Optional 23" Rod Holds 18"H Material
- Optional 45" Rod Holds 40"H Material
- Optional 65" Rod Holds 60"H Material

For any rod over 25", it will be very difficult to move the mast up and down due to the counterbalance weight being less than the weight of the wrap. The operator will have to lift the wrap with no appreciable assistance from the counterbalance.



# INSTRUCTIONS TO CHANGE PARAMETER SETTINGS USING DIGITAL KEYPAD (ON THE DRIVE)

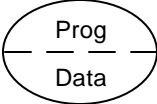

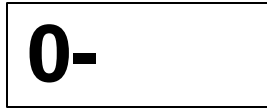

1) Press to  switch to the program mode.

a) The following screen will appear:



Indicating the specified parameter group.

b) Use the following keys to change all parameter settings in Step 2.

	Press "PROG/DATA" key to select parameter group and to store entered data. "END" displays for approx. 0.5 sec. if input has been accepted.
	Press "MODE" to scroll through all status at the drive" To show the turntable speed on the display, press "mode" three times after initial power-up. For example, when the turntable is rotating at 12 rpm, the display will appear as "u 12."
	Press "UP" or "DOWN" key to scroll through different parameters.
	Press "UP" or "DOWN" key momentarily will change parameter settings in single-unit increments.

2) Parameter settings need to be changed.

Parameter	Parameter Description	Setting	Setting Description
0-05	User Defined Coefficient K	BSWA-48: d 0.3 BSWA-54/60: d 0.2	BSWA-48: 15 RPM BSWA-54/60: 12 RPM
1-100	Maximum Output Frequency:	BSWA-48: d 50 BSWA-54/60 d 55	Sets the AC drive's maximum rotation speed
1-15	Auto-Acceleration/Deceleration	d 3 Auto Acceleration / Deceleration	The AC drive will automatically adjust the time of acceleration and deceleration to the load.
2-00	Source of Frequency Command	d 3	The turntable speed is determined by the potentiometer on the digital keypad.
2-01	Source of Operation Command	d 1	Drive is controlled by the external switch: keypad STOP is enable.
2-02	Stop Method	d 1 Coast Stop	The AC drive stops output immediately upon command, and the motor coasts until it comes to a complete stop.

---

# TROUBLESHOOTING GUIDE

## **PROBLEM**

1.) Turntable doesn't rotate when the foot pedal is depressed.

## **OBSERVATION**

- a.) Nothing is showing on the display of the speed controller.
- b.) The fan on top of the motor spins.
- c.) The fan on the top of the motor doesn't spin, and the RUN LED indicator is not lit.
- d.) The drive display indicates a fault condition.
- e.) The motor only hums, and gets hot quickly.

## **CORRECTIVE ACTION**

- a.) Check that the power cord is plugged in. Check the power source. Consult the factory.
- b.) Check for a broken drive chain, for torque limiter slippage (see page 3, 8 and 9 of the owner's manual), or for a broken gear reducer shaft key.
- c.) Check the foot switch and its cable for continuity when it's depressed.
- d.) Check the speed control knob setting. Check for overload condition.
- e.) Check for a loose connection at, or between, the drive and the motor that could cause single-phasing of the motor.

2.) Turntable maximum speed decreases.

- a.) Turntable spins slower when loaded, or won't reach maximum speed any longer.

- a.) Check for a build-up of material under the turntable and for torque limiter slippage.

3.) Stretch-wrap won't tension properly.

- a.) The top handle of the wrap holder doesn't tighten to the top of the stretch wrap material roll.

- a.) Verify the roll length. The standard rods are for 10" and 20" material.
- b.) Consult page 10 of the owner's manual to verify that the roll retainers are assembled into the roll's center tube properly.

4.) Stretch-wrap carrier won't hold position on the mast.

- a.) The carrier slides up or down the mast on its own when the operator lets go of its handle.

- a.) Slightly loosen the lock nut on the end of the carriage handle. See page 9 of the manual.

Electronic speed controls are susceptible to electrical noise and interference on the power supply. If the power supply quality creates nuisance tripping of the drive, a line reactor is recommended.

# WARNING LABEL IDENTIFICATION

MAKE SURE ALL WARNING LABELS ARE IN PLACE!

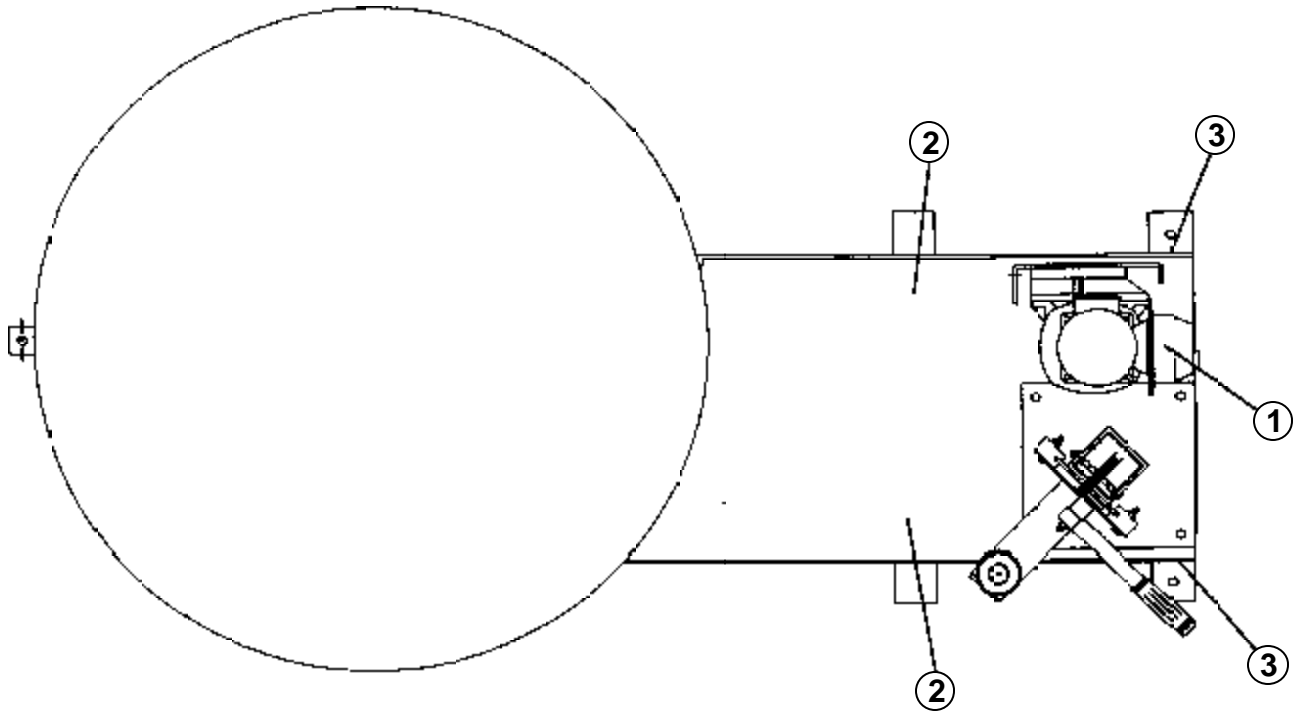

\*Product safety signs or labels should be periodically inspected and cleaned by the product users as necessary to maintain good legibility for safe viewing distance...ANSI 535.4 (10.21)  
Contact manufacturer for replacement labels.

Not Shown

④ **Attach the Green Wire From the Motor Speed Control Here**  
**Agarre el Alambre Verde del Control de Velocidad del Motor Aqui** 402

Not Shown

⑤ **Attach to Machine's Grounding Screws**  
**Agarre a los Tornillos del Piso de la Maquina** 401

①

<b>DANGER</b> ⚠	SHUT POWER OFF AND CONSULT OWNERS MANUAL BEFORE WORKING ON THIS EQUIPMENT
<b>PELIGRO</b> ⚠	CORTE LA CONSULTE Y CONSULTE EL MANUAL DEL PROPIETARIO ANTES DE TRABAJAR EN ESTE EQUIPO
<b>DANGER</b> ⚠	COUPER LE COURANT ET CONSULTER LE MANUEL D'UTILISATION AVANT DE TRAVAILLER SUR CET ÉQUIPEMENT. 221

②

<b>⚠ WARNING</b>	<b>⚠ AVISO</b>	<b>⚠ AVERTISSEMENT</b>
KEEP CLEAR WHEN IN USE	MANTENGASE ALEJADO CUANDO SE ESTA OPERANDO	SE TENIR À DISTANCE LORS DU FONCTIONNEMENT 220

③

<b>⚠ WARNING</b>	<b>⚠ AVISO</b>	<b>⚠ AVERTISSEMENT</b>
SECURE FRAME TO FLOOR	ASEGURE EL BASTIDOR AL PISO	FIXER SOLIDEMENT LE CADRE AU PLANCHER

204

---

# LIMITED WARRANTY

**ONE YEAR LIMITED WARRANTY.** The manufacturer warrants for the original purchaser against defects in materials and workmanship under normal use one year after date of purchase. (Not to exceed 15 months after date of manufacture.) Any part which is determined by the manufacturer to be defective in material or workmanship and returned to the factory, shipping costs prepaid, will be, as the exclusive remedy, repaired or replaced at our option. Labor costs for warranty repairs and/or modifications are not covered unless done at manufacturer's facilities. Any modifications performed without written approval of the manufacturer may void warranty. This limited warranty gives purchaser specific legal rights which vary from state to state.

**LIMITATION OF LIABILITY.** To the extent allowable under applicable law, the manufacturer's liability for consequential and incidental damages is expressly disclaimed. The manufacturer's liability in any event is limited to, and shall not exceed, the purchase price paid. Misuse or modification may void warranty.

**WARRANTY DISCLAIMER.** Our company has made a diligent effort to illustrate and describe the products shown accurately; however, such illustrations and descriptions are for the sole purpose of identification, and do not express or imply a warranty that the products are merchantable, or fit for a particular purpose, or that the products will necessarily conform to the illustrations or descriptions.

The provisions of the warranty shall be construed and enforced in accordance with the **UNIFORM COMMERCIAL CODE** and laws as enacted in the State of Indiana.

**DISPOSITION.** Our company will make a good faith effort for prompt correction or other adjustment with respect to any product which proves to be defective within the Limited Warranty. Warranty claims must be made in writing within said year.

---

## SERVICE RECORD

DATE OF SERVICE: ____/____/____
WORK DONE BY: _____
SERVICE PERFORMED: _____
_____
_____

DATE OF SERVICE: ____/____/____
WORK DONE BY: _____
SERVICE PERFORMED: _____
_____
_____

DATE OF SERVICE: ____/____/____
WORK DONE BY: _____
SERVICE PERFORMED: _____
_____
_____

DATE OF SERVICE: ____/____/____
WORK DONE BY: _____
SERVICE PERFORMED: _____
_____
_____

DATE OF SERVICE: ____/____/____
WORK DONE BY: _____
SERVICE PERFORMED: _____
_____
_____

DATE OF SERVICE: ____/____/____
WORK DONE BY: _____
SERVICE PERFORMED: _____
_____
_____